

NOTES  
LEVELS REALTED TO OSBM ON  
NEWBIGGIN. VALUE 31.67M AOD

KEY TO SYMBOLS / ANNOTATION  
 STN - SURVEY STATION  
 IC - INSPECTION COVER  
 G - GULLY GRADE  
 GV - GAS STOP VALVE  
 GP - GAS STOP POINT  
 FH - FIRE HYDRANT  
 FT - FELLISMAN TELECOM CENTER  
 EP - ELECTRICITY POLE  
 BS - BENCH MARK  
 DBSH - DRAINAGE SURVEY BENCH MARK

*09/10/2009/FW*  
 RYEDALE D.C.  
 - 9 DEC 2009

DEVELOPMENT CONTROL

PLANNING

NO	REVISION	DATE	BY	FOR
1	ISSUED FOR PERMIT	09/11/08	W.R.DUNN	PLANNING

W.R.DUNN & CO LTD.  
 CHARTERED BUILDING SURVEYORS  
 & ARCHITECTS.  
 27 FRONT STREET, ACORN, YORK, YO24 8BW

Client  
 FITZWILLIAM (MALTON) ESTATES

Site No.  
 48 & 51 WHEELGATE  
 MALTON

Drawing Title  
 EXISTING  
 SITE PLAN

Scale 1:100 @ A1 1:200 @ A4  
 Drawn MS  
 Date SEP 2008  
 Checked RP

Drawing Number  
 GZ933 - 001 - A

THIS COPY HAS BEEN MADE BY OR WITH THE  
 AUTHORITY OF THE DISTRICT COUNCIL  
 UNLESS OTHERWISE STATED  
 ANY REPRODUCTION OR TRANSMISSION  
 WITHOUT PERMISSION IS PROHIBITED  
 COPYRIGHT © 2008

E 487.408  
 AHT 25.071  
 STN

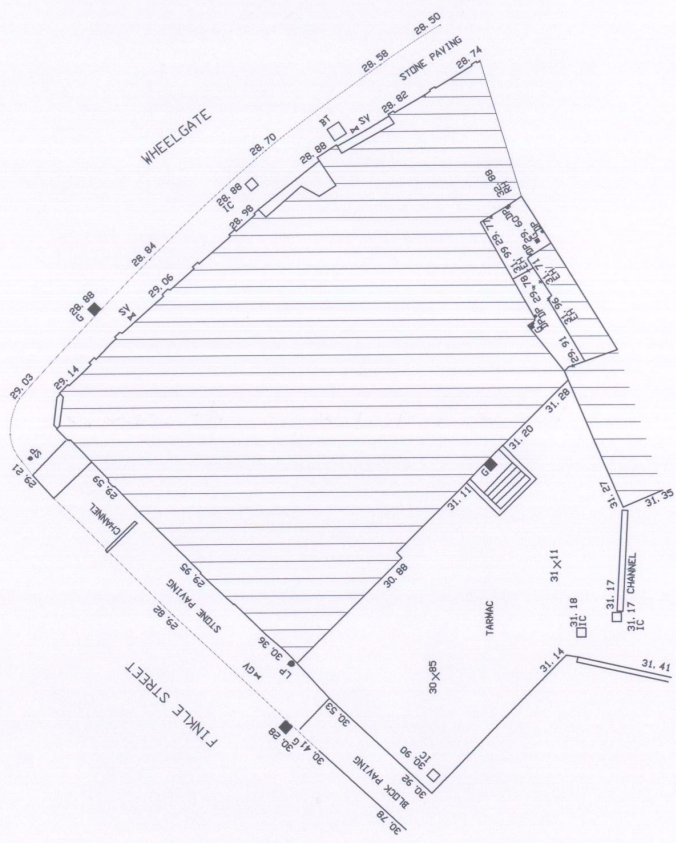
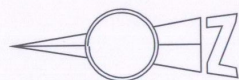
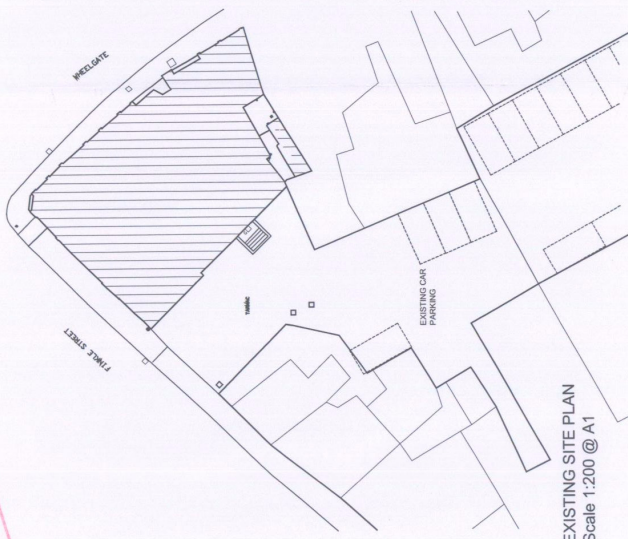

EXISTING PART SITE PLAN  
 Scale 1:100



**N.O.T.E.**  
Do not scale from this drawing or consider any dimension or room position as accurate.  
North point shown approximately only.

In the event of any discrepancy being found, these should be brought to the attention of the Architect for further instruction.

- The proposed layouts are subject to the following, although not limited to:
1. Structural Engineers Requirements.
  2. Mechanical and Electrical Engineers Requirements.
  3. Fire Engineers Requirements.
  4. Planning / Building Control approvals as appropriate.

**LEVELS RELATED TO OSBM ON NEWBIGGIN  
VALUE 31.67M AOD**

**RYEDALE D.C.**

**- 9 DEC 2009**

*W.R. Dunn*  
**W.R. DUNN & CO LTD**  
**DEVELOPMENT CONTROL**

**PLANNING**

**W.R. DUNN & CO LTD.**  
CHARTERED BUILDING SURVEYORS  
& ARCHITECTS.  
27 FRONT STREET, ACOMA, YORK, YO2 9BW  
TEL: 01904 473333 FAX: 01904 473334

Client:  
**FITZWILLIAM (MALTON) ESTATES**

Job Title:  
**49 & 51 WHEELGATE  
MALTON**

Drawing Title:  
**PROPOSED  
SITE PLAN**

Scale 1:100 @ A1	Drawn	PEC
Date: NOV 2009	Checked	EC

Drawing Number:  
**G2933 - 404**

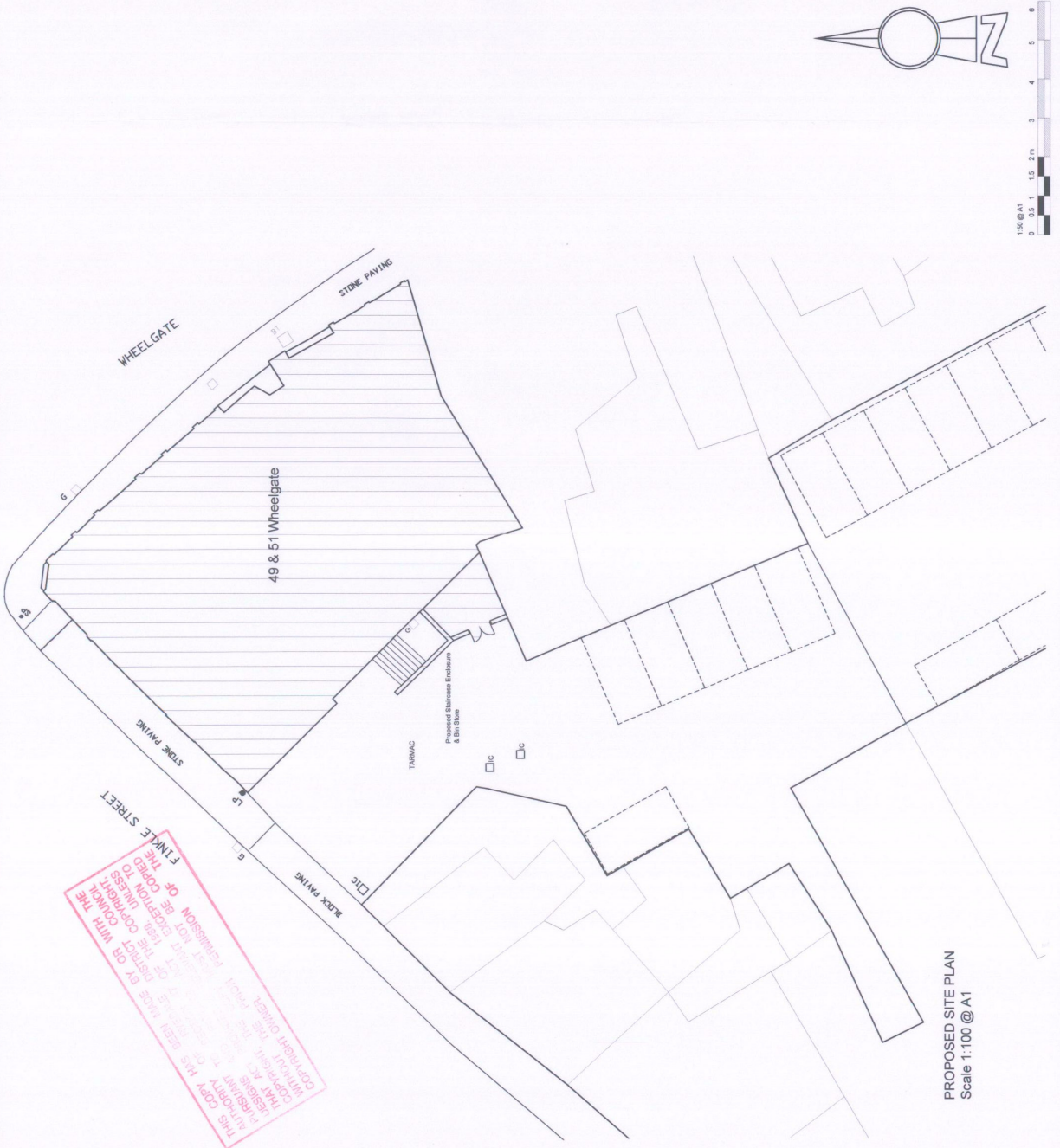

THIS COPY HAS BEEN MADE BY CO WITH THE  
 PERMISSION OF THE DISTRICT COUNCIL  
 THAT ANY FURTHER REPRODUCTION OR  
 DISTRIBUTION OF THIS COPY MUST BE  
 APPROVED BY THE DISTRICT COUNCIL  
 OFFICE, 100, FINKE STREET, MALTON,  
 NORTH YORKSHIRE, YO2 9BW.

**PROPOSED SITE PLAN  
Scale 1:100 @ A1**